

Proposed Alignment - Parking Implications (Phase 1)

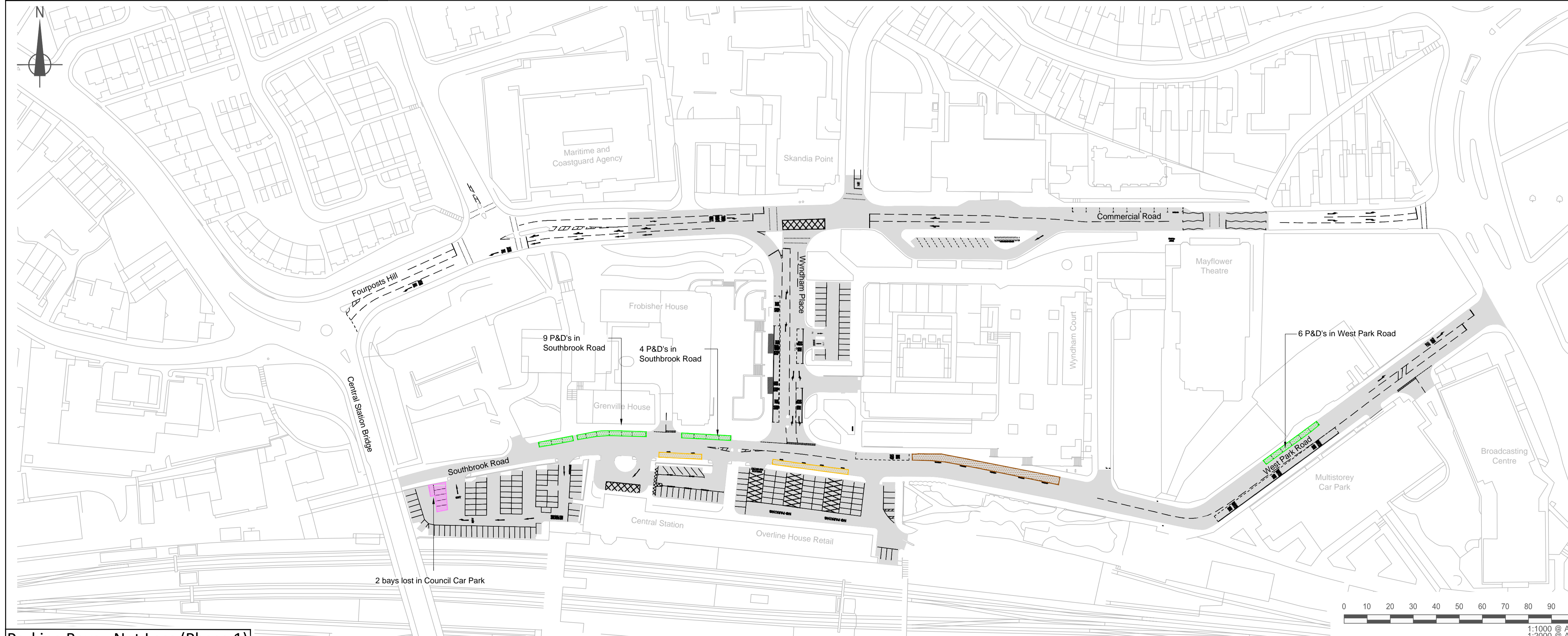

Parking Bays - Net Loss (Phase 1)

Reproduced by permission of Ordnance Survey on behalf of HMSO. Crown copyright and database right 2013. All rights reserved. Ordnance Survey Licence number: 100048446

Notes:

1. Print in colour.

Key:

- Pay and display short term
- Pay and display long term
- Taxi parking
- Coach parking
- Phase 1 construction works

Southampton City Council	
Pay and display short term	-18
Taxi parking	+10

Station Forecourt/Car Park	
Parking bays net loss (PH 1)	-2

Rev	By	Chkd	Apprvd	Date	Description
P0	REA	PMN	CW	24-06-13	For information only

Client

Balfour Beatty
Living Places

Halcrow Group Limited
Elms House, 43 Brook Green, London, W6 7EF
Tel +44 (0)20 3479 8000 Fax +44 (0)20 3479 8001
www.halcrow.com

Halcrow
A CH2M HILL COMPANY

Project
Southampton Station Quarter

Drawing
**Existing and Proposed Parking
Phase 1**

Drawn by: REA Date: 24-06-13

Checked by: PMN Date: 24-06-13

Approved by: CW Date: 24-06-13

Drawing No. Revision

201015-BE-000-034 P0

Drawing Scale: as shown @ A1

